



Engine Block

Illustrated Index

 Lubricate all internal parts with engine oil during reassembly.

NOTE:

- Apply liquid gasket to the mating surfaces of the left side cover and oil pump case before installing them.
- Use liquid gasket, part No. 08718-0001.
- If the bottom of the oil pan is deformed, it should be repaired or the oil pan should be replaced retain proper clearance between the screen and the bottom.

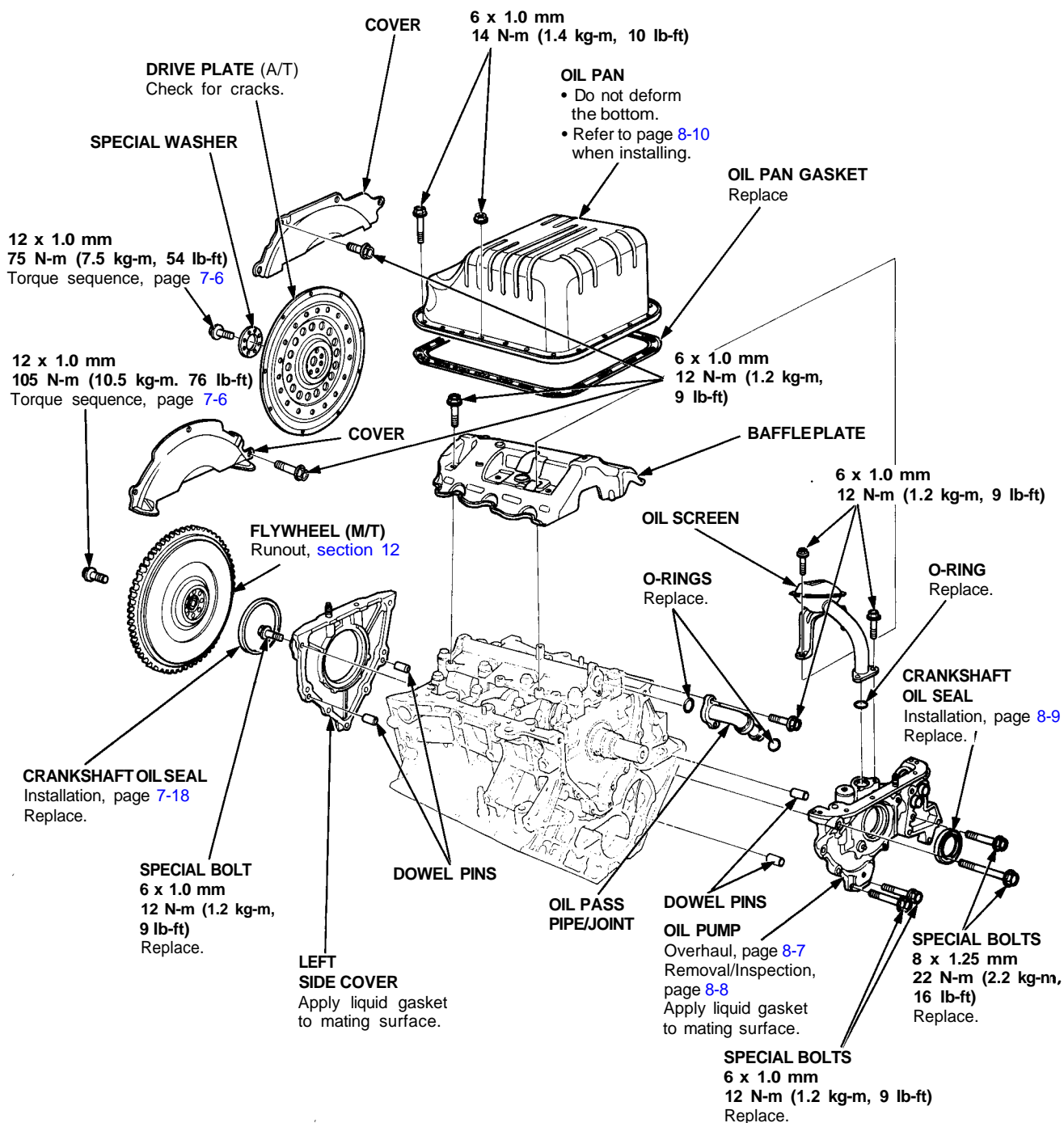

(cont'd)

Engine Block

Illustrated Index (cont'd)



Lubricate all internal parts with engine oil during reassembly.

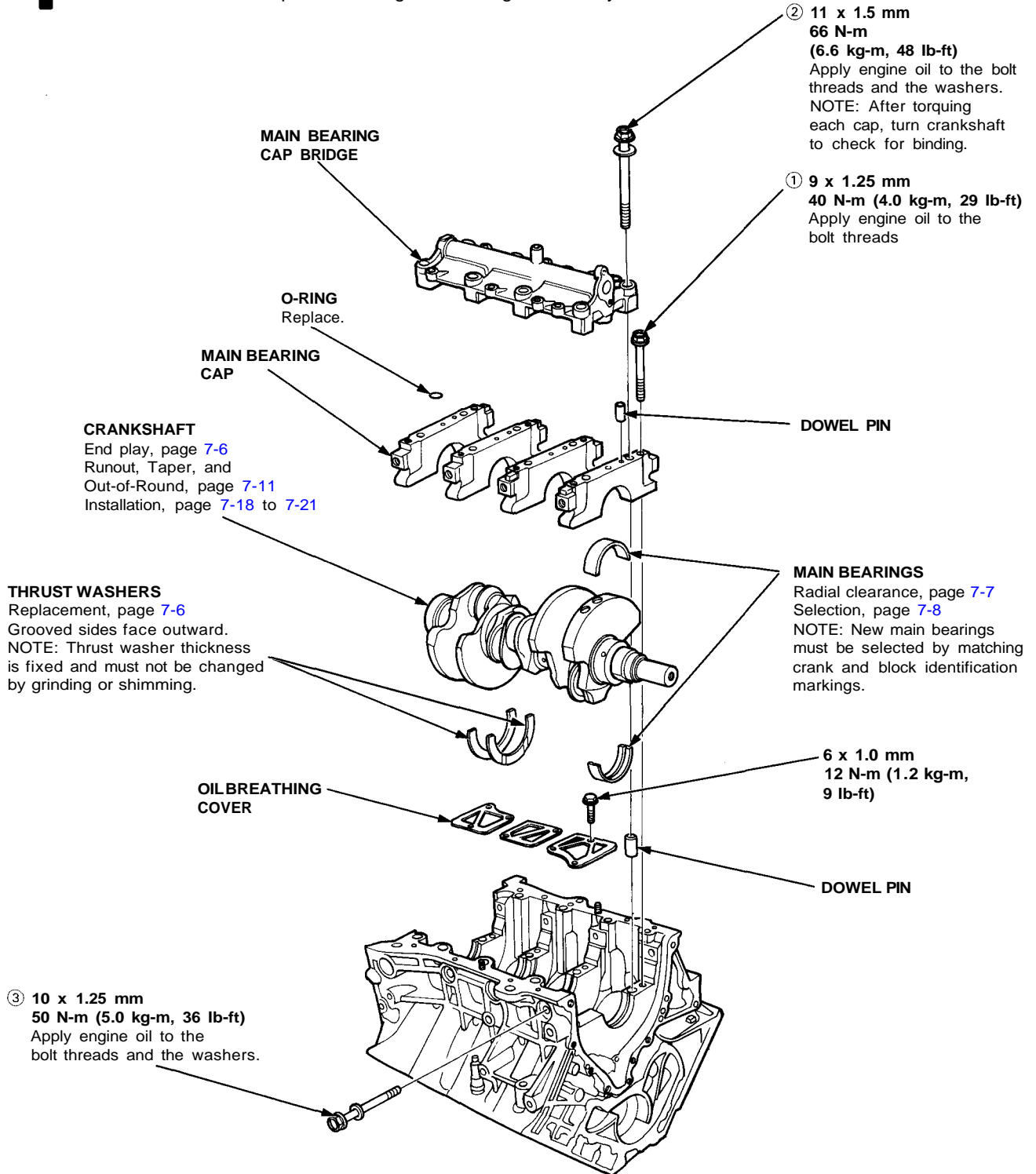



NOTE: New rod bearings must be selected by matching connecting rod assembly and crankshaft identification markings (see page 7-8).

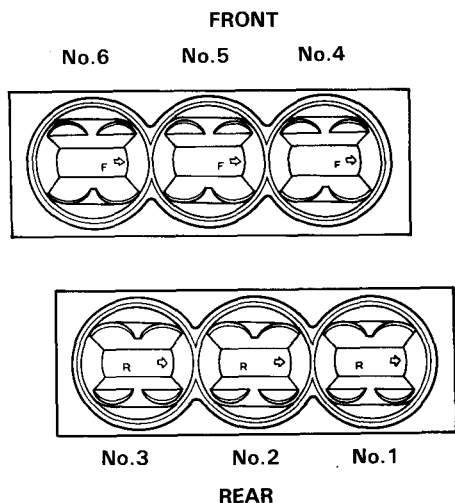

CAUTION:

- The piston skirt is coated with molybdenum; handle the piston carefully to prevent any damage.
- The connecting rods are made of titanium. Attempting to remove the piston pin with conventional shop equipment will damage the connecting rod.
- If the piston, connecting rod, or piston pin require replacement, all three must be replaced as an assembly.

PISTON

Inspection, page 7-13

NOTE:

- Before removing piston, inspect the top of the cylinder bore for carbon build-up or ridge. Remove ridge if necessary, page 7-9.
- To maintain proper piston clearance, match the letter on the piston top (No letter denotes A.) with the letter for each cylinder stamped on the block.

CONNECTING ROD ASSEMBLY

End play, page 7-6
Selection, page 7-14

CONNECTING ROD BEARINGS

Clearance, page 7-7
Selection, page 7-8

PISTON RINGS

Replacement, page 7-15
Measurement, pages 7-15 and 7-16
Alignment, page 7-16

CONNECTING ROD BOLT

Inspect top of each cylinder bore for carbon build-up or ridge before removing piston.
Remove ridge if necessary, page 7-9

ENGINE BLOCK

Cylinder bore inspection, page 7-12
Warpage inspection, page 7-12
Cylinder bore honing, page 7-13

CONNECTING ROD WASHER



CYLINDER BORE SIZES

NOTE: To maintain proper piston clearance, match these letters with the letters on the pistons. The letters on the block read from left to right, No. 1 through No. 3. cylinders on the first line and No. 4 through No. 6 cylinders on the second line.

CONNECTING ROD CAP NUT
8 x 0.75 mm

20 N-m (2.0 kg-m, 14 lb-ft)
then turn 95°

After torquing each bearing cap, rotate crankshaft to check for binding.

CONNECTING ROD BEARING CAP

Installation, page 7-18 to 7-21
NOTE: Install caps so the bearing recess is on the same side as the recess in the rod.