

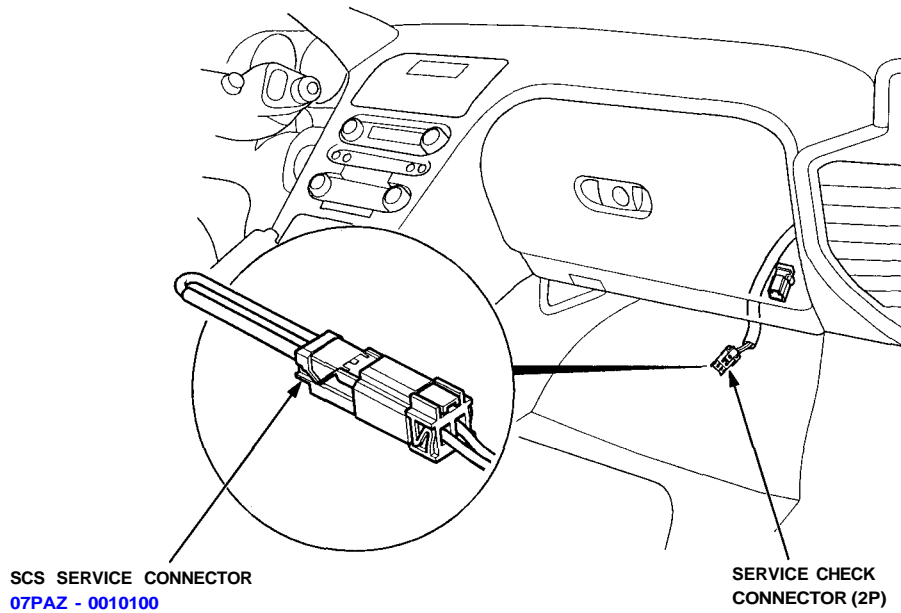

# Diagnostic Trouble Code (DTC) Indication

1. Connect the SCS service connector to the service check connector under the glove box.



2. Turn the ignition switch ON (II), but do not start the engine.
3. Record the blinking frequency of the EPS indicator light. The blinking frequency indicates the diagnostic trouble code (DTC).

NOTE: Check the DTC carefully and record it. The memory of the DTC is erased if the connector is disconnected from the EPS control unit.

GAUGE ASSEMBLY

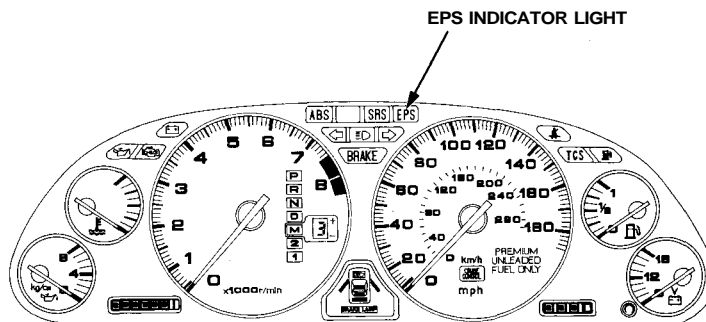

# Diagnostic Trouble Code (DTC) Indication

Example:

DTC Indication Pattern:

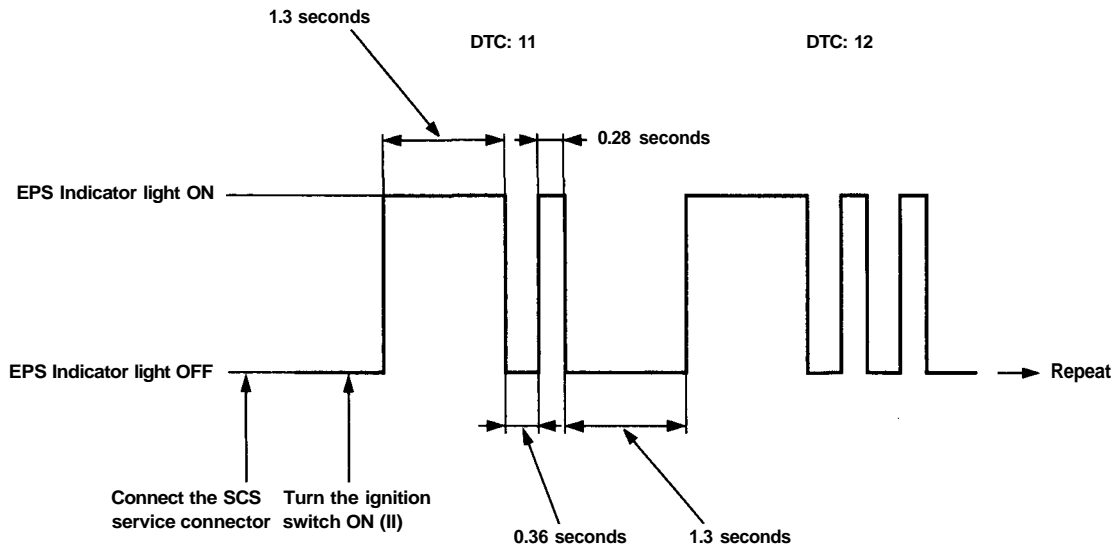

- The DTC is indicated by a series of long and short blinks. One long blink equals 10 short blinks. Add the long and short blinks together to determine the DTC.
- The DTCs are repeated sequentially beginning with the lowest number.

4. Remove the SCS service connector.

NOTE: The Malfunction Indicator Lamp (MIL) will stay on after the engine is started if the SCS service connector is connected.

5. Remove the CLOCK (7.5 A) fuse in the under-hood fuse/relay box for more than 10 seconds to erase the EPS control unit memory.