

# Knuckle/Control Arms/Compliance Pivot

## Illustrated Index

### Overall Suspension

NOTE: Align the white line on the stabilizer bar with the bushing end, and install the stabilizer bar.

#### NOTE:

- Wipe off the grease before tightening the nut at the ball joint.
- Torque specifications, see page 18-14.

☆: Corrosion resistant bolt/nut

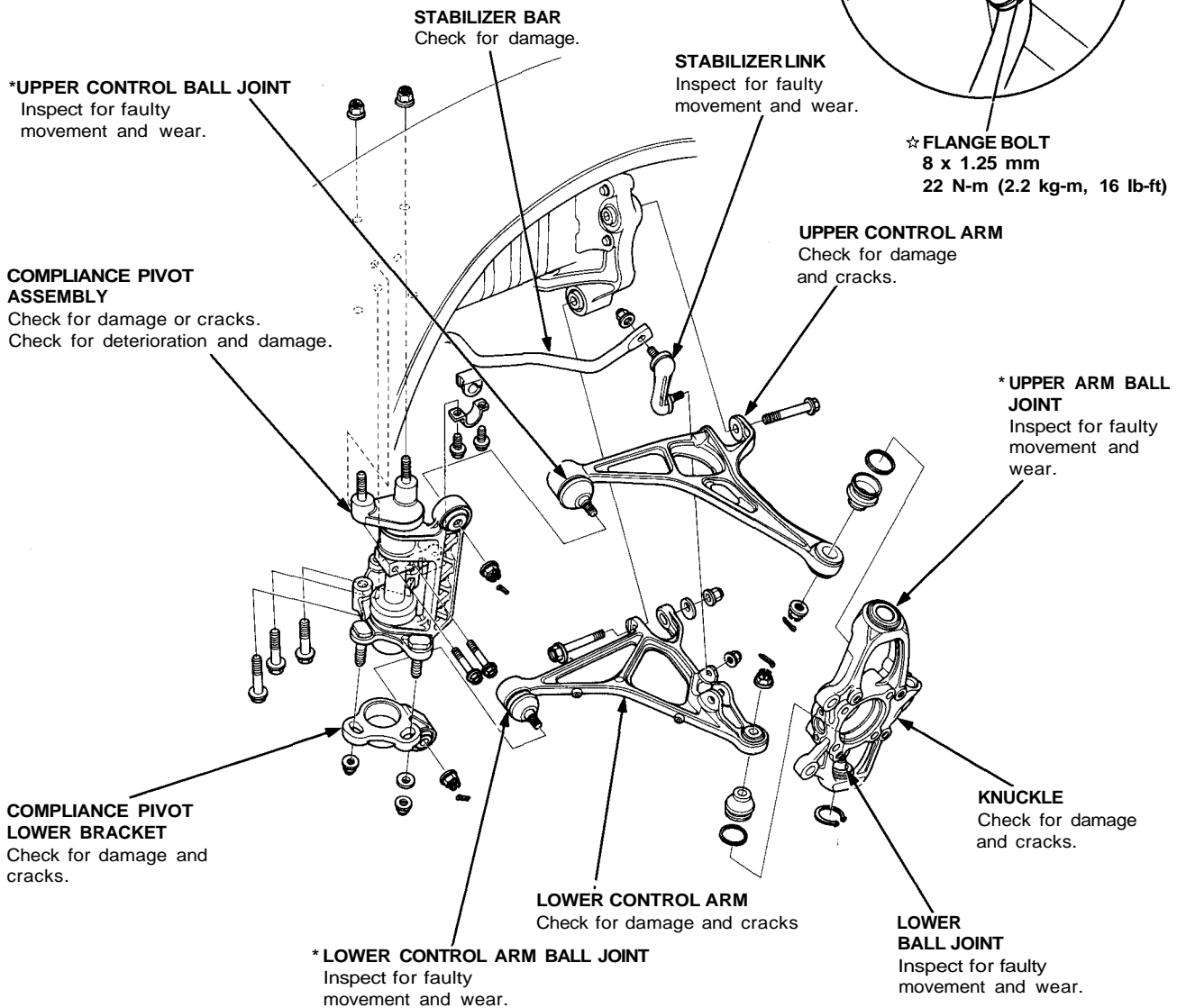

NOTE: Replace the joint boot if any are damaged. The parts marked with an asterisk (\*) have a retainer attaching the ball joints. Replace the retainer whenever the boot is replaced.

**CAUTION:** Do not remove the arms, knuckle, and compliance pivot by striking them with a hammer, and take care not to drop them.