

Illustrated Index

Left Side Cover

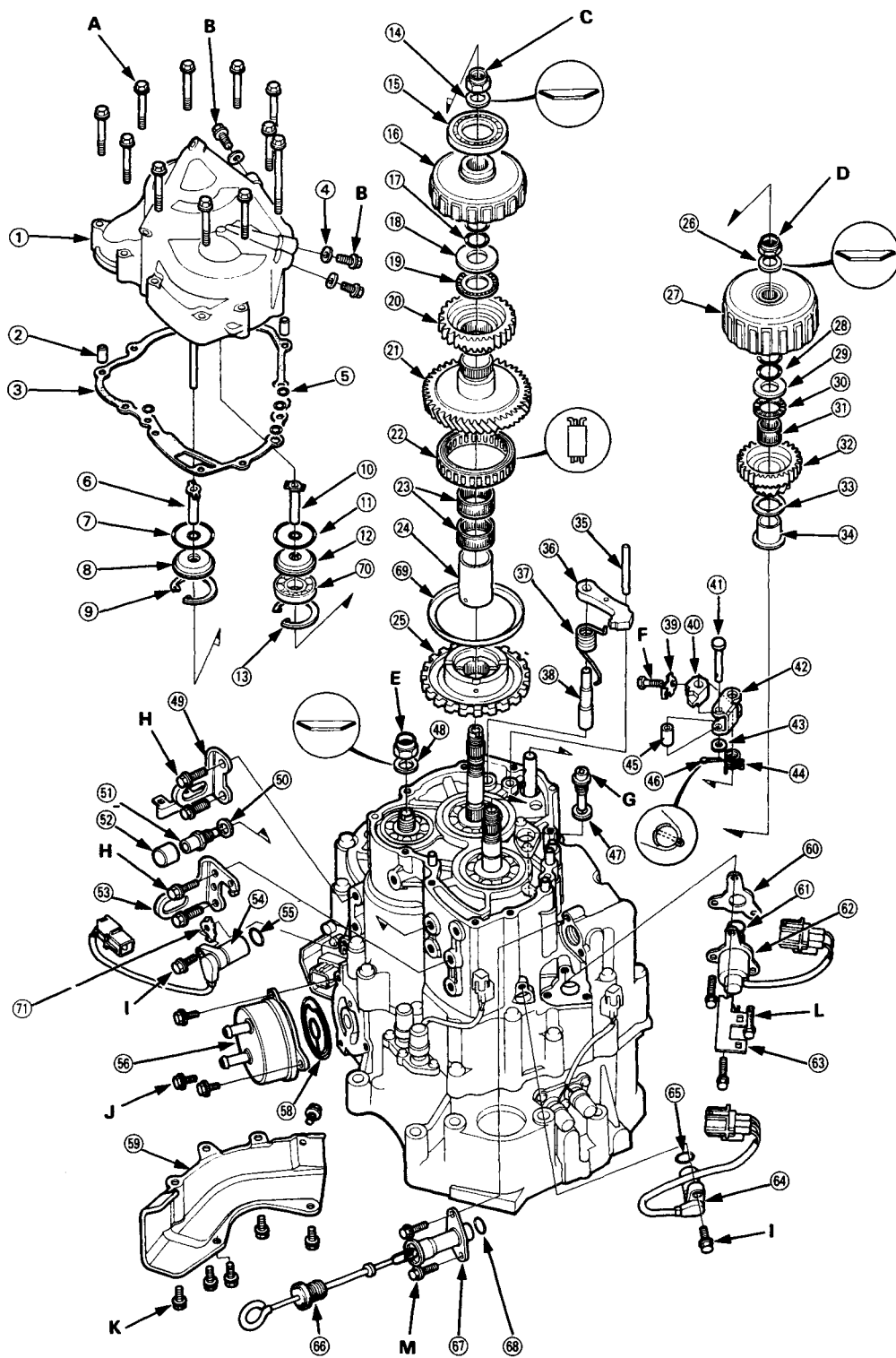



- | | |
|----------------------------------|---------------------------------------|
| ① LEFT SIDE COVER | ③⑥ PARKING BRAKE PAWL |
| ② DOWEL PIN | ③⑦ PARKING BRAKE PAWL SPRING |
| ③ GASKET Replace. | ③⑧ PARKING BRAKE PAWL SHAFT |
| ④ SEALING WASHER Replace. | ③⑨ LOCK WASHER Replace. |
| ⑤ O-RING Replace. | ④⑩ PARKING BRAKE STOPPER |
| ⑥ 1ST-HOLD CLUTCH FEED PIPE | ④① ROLLER PIN |
| ⑦ O-RING Replace. | ④② PARKING BRAKE LEVER |
| ⑧ FEED PIPE FLANGE | ④③ WASHER |
| ⑨ SNAP RING | ④④ PARKING BRAKE SPRING |
| ⑩ 1ST CLUTCH FEED PIPE | ④⑤ ROLLER |
| ⑪ O-RING Replace. | ④⑥ COTTER PIN Replace. |
| ⑫ FEED PIPE FLANGE | ④⑦ SEALING WASHER Replace. |
| ⑬ SNAP RING | ④⑧ CONICAL SPRING WASHER Replace. |
| ⑭ CONICAL SPRING WASHER Replace. | ④⑨ TRANSMISSION HANGER/CONNECTOR STAY |
| ⑮ BALL BEARING | ⑤⑩ SEALING WASHER Replace. |
| ⑯ 1ST-HOLD CLUTCH ASSEMBLY | ⑤① BREATHER JOINT |
| ⑰ O-RING Replace. | ⑤② BREATHER CAP |
| ⑱ THRUST WASHER | ⑤③ TRANSMISSION HANGER |
| ⑲ THRUST NEEDLE BEARING | ⑤④ COUNTERSHAFT SPEED SENSOR |
| ⑳ 1ST-HOLD CLUTCH HUB | ⑤⑤ O-RING Replace. |
| ㉑ COUNTERSHAFT 1ST GEAR | ⑤⑥ ATF COOLER |
| ㉒ ONE-WAY CLUTCH | ⑤⑧ ATF COOLER FILTER/GASKET Replace. |
| ㉓ NEEDLE BEARINGS | ⑤⑨ SPEED SENSOR COVER |
| ㉔ COUNTERSHAFT 1ST GEAR COLLAR | ⑥⑩ LINEAR SOLENOID SHIM |
| ㉕ PARKING GEAR | ⑥① O-RING Replace. |
| ㉖ CONICAL SPRING WASHER Replace. | ⑥② LINEAR SOLENOID |
| ㉗ 1ST CLUTCH ASSEMBLY | ⑥③ CONNECTOR STAY |
| ㉘ O-RING Replace. | ⑥④ MAINSHAFT SPEED SENSOR |
| ㉙ THRUST WASHER | ⑥⑤ O-RING Replace. |
| ㉚ THRUST NEEDLE BEARING | ⑥⑥ ATF LEVEL GAUGE |
| ㉛ NEEDLE BEARING | ⑥⑦ ATF LEVEL GAUGE PIPE |
| ㉜ MAINSHAFT 1ST GEAR | ⑥⑧ O-RING Replace. |
| ㉝ THRUST WASHER | ⑥⑨ RETAINER PLATE |
| ㉞ MAINSHAFT 1ST GEAR COLLAR | ⑦⑩ BALL BEARING |
| ㉟ PARKING BRAKE PAWL STOPPER | ⑦① COUNTERSHAFT SPEED SENSOR WASHER |

TORQUE SPECIFICATION

No.	TORQUE VALUE	BOLT SIZE	REMARKS
A	12 N·m (1.2 kg-m, 9 lb-ft)	6 x 1.0 mm	
B	18 N·m (1.8 kg-m, 13 lb-ft)	8 x 1.25 mm	OIL PRESSURE CHECK BOLT
C	140 N·m (14.0 kg-m, 101 lb-ft)	24 x 1.25 mm	COUNTERSHAFT LOCKNUT (Left-hand threads) Replace.
D	140 N·m (14.0 kg-m, 101 lb-ft)	23 x 1.25 mm	MAINSHAFT LOCKNUT Replace.
E	140 N·m (14.0 kg-m, 101 lb-ft)	24 x 1.25 mm	SECONDARY SHAFT LOCKNUT Replace.
F	14 N·m (1.4 kg-m, 10 lb-ft)	6 x 1.0 mm	Special bolt (Replace.)
G	50 N·m (5.0 kg-m, 36 lb-ft)	18 x 1.5 mm	DRAIN PLUG
H	30 N·m (3.0 kg-m, 22 lb-ft)	8 x 1.25 mm	
I	12 N·m (1.2 kg-m, 9 lb-ft)	6 x 1.0 mm	
J	30 N·m (3.0 kg-m, 22 lb-ft)	8 x 1.25 mm	ATF COOLER BOLT
K	12 N·m (1.2 kg-m, 9 lb-ft)	6 x 1.0 mm	
L	10 N·m (1.0 kg-m, 7 lb-ft)	6 x 1.0 mm	LINEAR SOLENOID BOLT
M	12 N·m (1.2 kg-m, 9 lb-ft)	6 x 1.0 mm	