

Illustrated Index

Transmission Housing

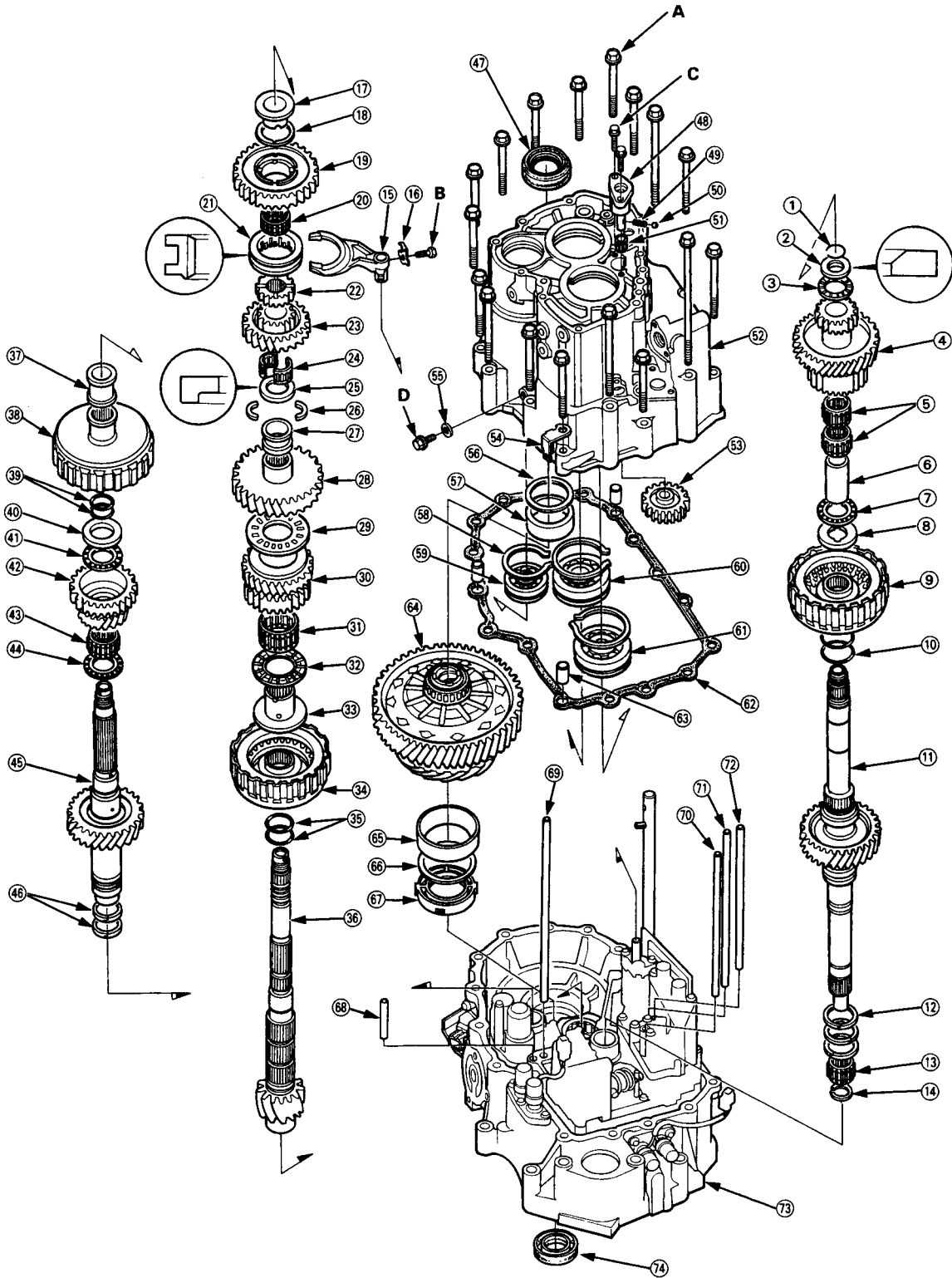



- | | | | |
|---|----------------------------------|----|---------------------------------|
| ① | SNAP RING | ③⑧ | 2ND CLUTCH ASSEMBLY |
| ② | WASHER | ③⑨ | O-RINGS Replace. |
| ③ | THRUST NEEDLE BEARING | ④⑩ | THRUST WASHER |
| ④ | MAINSHAFT 4TH GEAR | ④① | THRUST NEEDLE BEARING |
| ⑤ | NEEDLE BEARINGS | ④② | SECONDARY SHAFT 2ND GEAR |
| ⑥ | MAINSHAFT 4TH GEAR COLLAR | ④③ | NEEDLE BEARING |
| ⑦ | THRUST NEEDLE BEARING | ④④ | THRUST NEEDLE BEARING |
| ⑧ | THRUST WASHER | ④⑤ | SECONDARY SHAFT |
| ⑨ | 4TH CLUTCH ASSEMBLY | ④⑥ | SEALING RING 35 mm |
| ⑩ | O-RING Replace. | ④⑦ | DIFFERENTIAL OIL SEAL Replace. |
| ⑪ | MAINSHAFT | ④⑧ | REVERSE IDLER GEAR SHAFT/HOLDER |
| ⑫ | SEALING RING 37 mm | ④⑨ | REVERSE IDLER GEAR SHAFT SPRING |
| ⑬ | NEEDLE BEARING | ⑤⑩ | STEEL BALL (7/32) #7 |
| ⑭ | SET RING | ⑤① | NEEDLE BEARING |
| ⑮ | REVERSE SHIFT FORK | ⑤② | TRANSMISSION HOUSING |
| ⑯ | LOCK WASHER Replace. | ⑤③ | REVERSE IDLER GEAR |
| ⑰ | COUNTERSHAFT REVERSE GEAR COLLAR | ⑤④ | CONNECTOR STAY |
| ⑱ | THRUST WASHER | ⑤⑤ | SEALING WASHER Replace. |
| ⑲ | COUNTERSHAFT REVERSE GEAR | ⑤⑥ | THRUST SHIM |
| ⑳ | NEEDLE BEARING | ⑤⑦ | BEARING OUTER RACE |
| ㉑ | REVERSE SELECTOR | ⑤⑧ | SNAP RING |
| ㉒ | REVERSE SELECTOR HUB | ⑤⑨ | SECONDARY SHAFT BALL BEARING |
| ㉓ | COUNTERSHAFT 4TH GEAR | ⑥⑩ | COUNTERSHAFT BALL BEARING |
| ㉔ | NEEDLE BEARING (Separate type) | ⑥① | MAINSHAFT BALL BEARING |
| ㉕ | COTTER RETAINER | ⑥② | GASKET Replace. |
| ㉖ | COTTERS | ⑥③ | DOWEL PIN |
| ㉗ | COUNTERSHAFT 2ND GEAR SPACER | ⑥④ | DIFFERENTIAL GEAR ASSEMBLY |
| ㉘ | COUNTERSHAFT 2ND GEAR | ⑥⑤ | BEARING OUTER RACE |
| ㉙ | THRUST NEEDLE BEARING | ⑥⑥ | THRUST SHIM |
| ㉚ | COUNTERSHAFT 3RD GEAR | ⑥⑦ | DIFFERENTIAL OIL GUIDE RING |
| ㉛ | NEEDLE BEARING | ⑥⑧ | 2ND CLUTCH FEED PIPE |
| ㉜ | THRUST NEEDLE BEARING | ⑥⑨ | 1ST-HOLD CLUTCH FEED PIPE |
| ㉝ | COUNTERSHAFT 3RD GEAR COLLAR | ⑦⑩ | 4TH CLUTCH FEED PIPE |
| ㉞ | 3RD CLUTCH ASSEMBLY | ⑦① | 1ST CLUTCH FEED PIPE |
| ㉟ | O-RING Replace. | ⑦② | 3RD CLUTCH FEED PIPE |
| ㊱ | COUNTERSHAFT | ⑦③ | TORQUE CONVERTER HOUSING |
| ㊲ | SPACER 31 mm | ⑦④ | DRIVESHAFT OIL SEAL Replace. |

TORQUE SPECIFICATION

No.	TORQUE VALUE	BOLT SIZE	REMARKS
A	55 N·m (5.5 kg-m, 40 lb-ft)	10 x 1.25 mm	
B	14 N·m (1.4 kg-m, 10 lb-ft)	6 x 1.0 mm	Special bolt
C	12 N·m (1.2 kg-m, 9 lb-ft)	6 x 1.0 mm	
D	18 N·m (1.8 kg-m, 13 lb-ft)	8 x 1.25 mm	OIL PRESSURE CHECK BOLT