

Knuckle/Control Arms/Compliance Pivot

Illustrated Index

Overall Suspension

NOTE: Align the white line on the stabilizer bar with the bushing end and install the stabilizer bar.

NOTE:

- Wipe off the grease before tightening the nut at the ball joint.
- Torque specifications, see page 18-14.

☆ Corrosion resistant bolt/nut

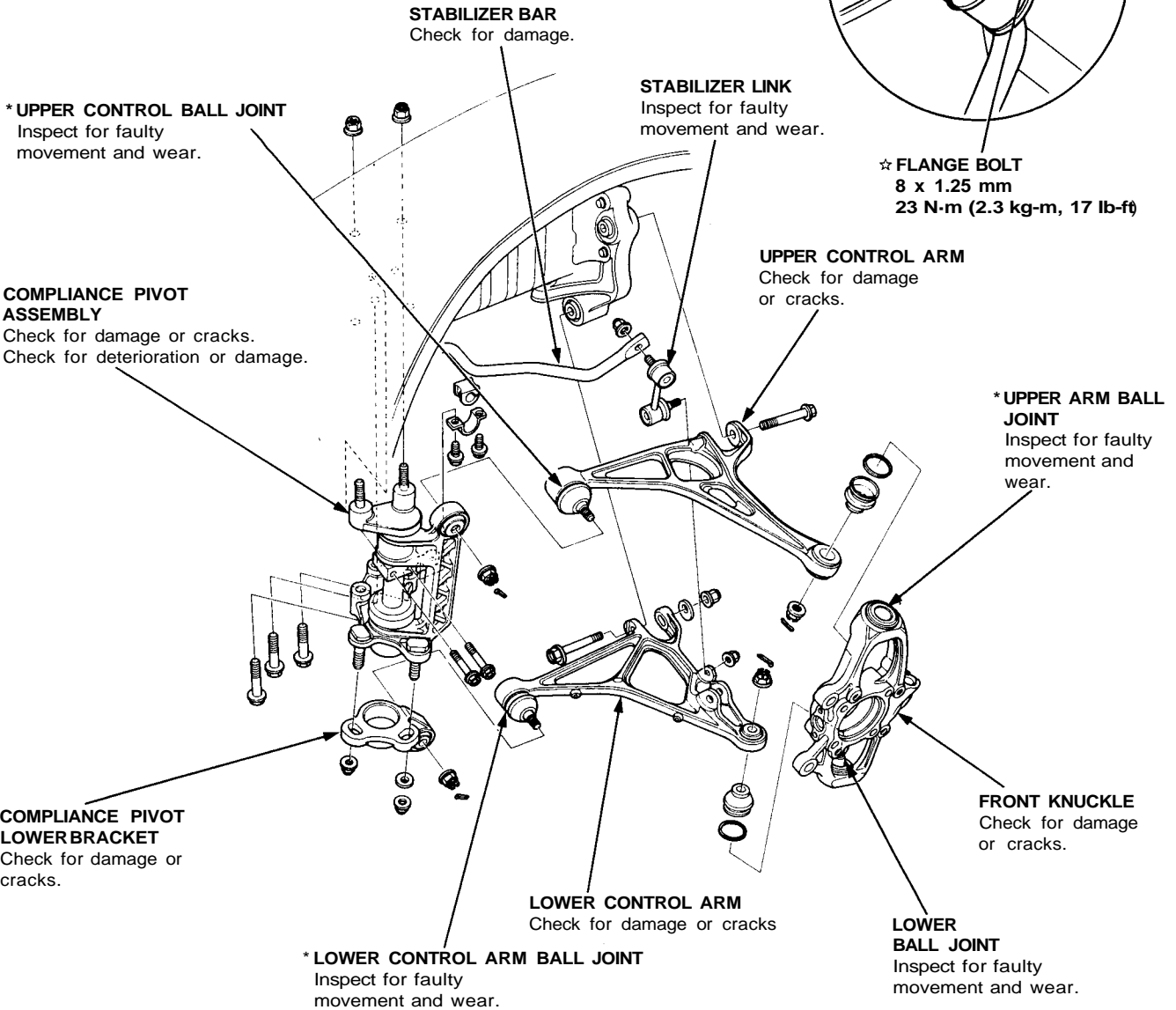
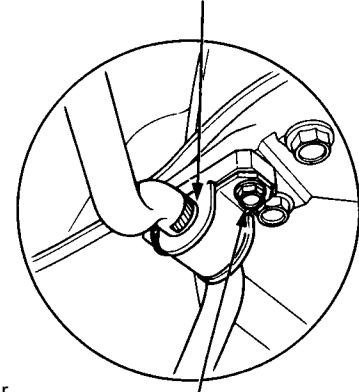

NOTE: Replace the joint boot if any are damaged. The parts marked with an asterisk (*) have a retainer attaching the ball joints. Replace the retainer whenever the boot is replaced.

CAUTION: Do not remove the arms, knuckle, and compliance pivot by striking them with a hammer, and take care not to drop them.