

# System Description

## System Connectors [Behind the bulkhead panels] (cont'd)

---

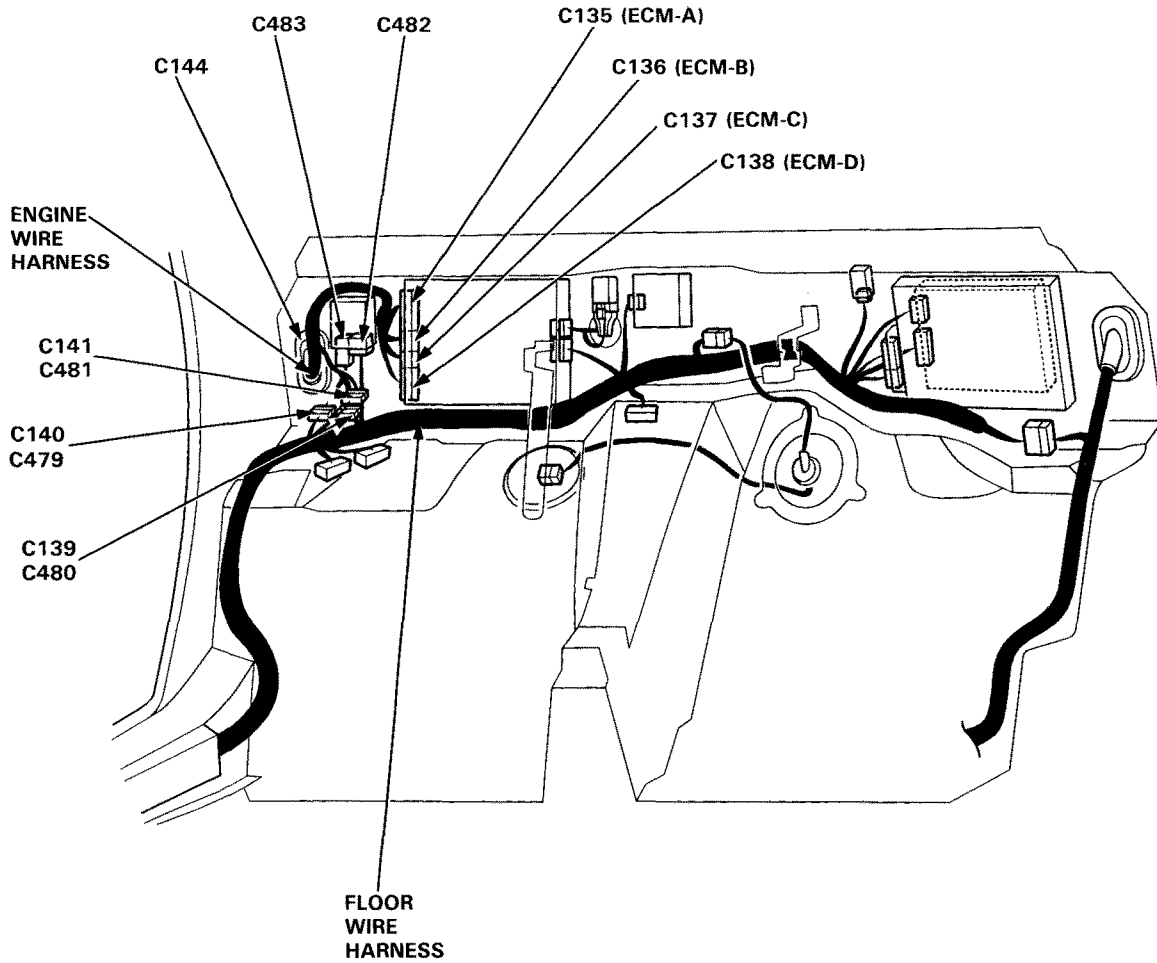



C135 (ECM-A)

1	2	3	4	5	6	7	8	9	10	11	12	13
14	15	16	17	18	19	20	21	22	23	24	25	26

①	BRN <sub>1</sub>	⑭	YEL
②	RED <sub>1</sub>	⑮	BLK/RED
③	BLU <sub>1</sub>	⑯	WHT/BLU
④	GRN/BLK	17	---
5	---	⑰	BLU/YEL
⑥	GRN	⑲	GRN/YEL
⑦	BLU <sub>2</sub>	⑳	PNK/BLU
⑧	RED/BLU	㉑	RED <sub>2</sub>
⑨	GRY	㉒	GRN/RED
⑩	LT GRN	㉓	ORN/BLK
⑪	PNK	㉔	BRN <sub>2</sub>
⑫	BLK <sub>1</sub>	⑳	BLK <sub>2</sub>
⑬	YEL/BLK	㉖	BRN/BLK

C136 (ECM-B)

1	2	3	4	5	6	7	8
9	10	11	12	13	14	15	16

①	BLU <sub>1</sub>	⑨	BRN/BLK
②	RED <sub>1</sub>	⑩	GRY
③	BLU/BLK	⑪	GRN
④	RED <sub>2</sub>	⑫	BLU <sub>2</sub>
⑤	LT GRN*	⑬	ORN/BLU <sub>2</sub>
⑥	ORN	⑭	WHT/BLU <sub>1</sub>
⑦	WHT	⑮	WHT/BLU <sub>2</sub>
⑧	ORN/BLU <sub>1</sub>	⑯	BLU/YEL
⑩	BLU/GRN		

\*: M/T

C137 (ECM-C)

1	2	3	4	5	6
7	8	9	10	11	12

①	YEL/BLK	⑦	ORN
②	BLU/BLK	⑧	GRN
③	RED/GRN	⑨	GRN/YEL
④	PNK	⑩	GRN/BLK
⑤	BLU	⑪	YEL/RED
⑥	BLK/WHT	⑫	YEL

C138 (ECM-D)

1	2	3	4	5	6	7	8	9	10	11
12	13	14	15	16	17	18	19	20	21	22

①	WHT/YEL <sub>1</sub>	⑫	RED/BLK
②	RED/BLU	⑬	WHT <sub>1</sub>
③	BRN	14	---
④	YEL/GRN	15	---
⑤	WHT/RED <sub>1</sub>	⑮	GRN
6	---	⑰	WHT/RED <sub>2</sub>
⑦	RED/WHT	⑯	BLU/RED
⑧	RED/YEL	⑲	WHT <sub>2</sub>
⑨	WHT/YEL <sub>1</sub>	㉑	WHT/BLK
⑩	YEL/BLU	㉒	BLU/GRN
⑪	GRN/BLU	㉓	WHT <sub>3</sub>

C144

1	2	3	4	5	6	7	8	9	10
11	12	13	14	15	16	17	18	19	20

①	GRN/BLU	⑪	BRN/BLK
②	GRN/BLU	⑫	BRN/BLK
③	GRN/BLU	⑬	BRN/BLK
④	GRN/BLU	⑭	BRN/BLK
⑤	YEL/BLK	⑮	YEL
⑥	YEL/BLK	⑯	YEL
⑦	YEL/BLK	⑰	YEL
⑧	YEL/BLU	⑱	YEL
⑨	YEL/BLU	⑲	YEL
⑩	YEL/BLU	㉑	YEL

C479

1	2	3	4	5	6	7	8	9
10	11	12	13	14	15	16	17	18

1	WHT/GRN	11	WHT/BLU
②	BLK	⑫	WHT/YEL <sub>1</sub>
③	BLK/RED	13	WHT/GRN
④	YEL/GRN	⑬	RED/GRN
⑤	YEL/BLK	⑮	BLU <sub>2</sub>
⑥	YEL	⑯	BLU/BLK
7	---	17	---
⑧	BRN/BLK	⑱	PNK
⑨	RED <sub>2</sub>	⑲	GRN
10	BLU/WHT	㉑	RED/WHT

C480

1	2	3	4	5	6	7	8
9	10	11	12	13	14	15	16

①	GRN/BLK	10	---
②	BLK/YEL	11	YEL/GRN
3	YEL/RED	12	---
④	PNK/BLU	13	---
5	---	14	BLU/RED
6	---	⑮	RED <sub>2</sub>
⑦	RED/BLK	⑯	WHT/YEL <sub>2</sub>
8	---	⑰	GRN
⑨	BLK/WHT	18	---

C481

1	2	3	4	5	6	7	8
---	---	---	---	---	---	---	---

1	---	5	ORN
②	RED/BLU	⑥	BLU
3	BRN/BLK	7	RED
4	YEL/BLK	⑧	BRN/BLK

C482

1	2	3	4	5	6	7	8
---	---	---	---	---	---	---	---

1	---	⑤	BLK/YEL
②	GRN/BLK	6	---
③	BLK/WHT	⑦	BLK <sub>1</sub>
4	---	8	---

C483

1	2	3	4
---	---	---	---

①	YEL/BLK
②	BLK/YEL
③	WHT/GRN
④	BLK/YEL

NOTE: • Different wires with the same color have been given a number suffix to distinguish them (for example, YEL/BLK<sub>1</sub> and YEL/BLK<sub>2</sub> are not the same).

○: Related to Fuel and Emissions System.

- Connector with male terminals (double outline): View from terminal side
- Connector with female terminals (single outline): View from wire side

(cont'd)

# System Description

## System Connectors [Behind the bulkhead panels](cont'd)

---

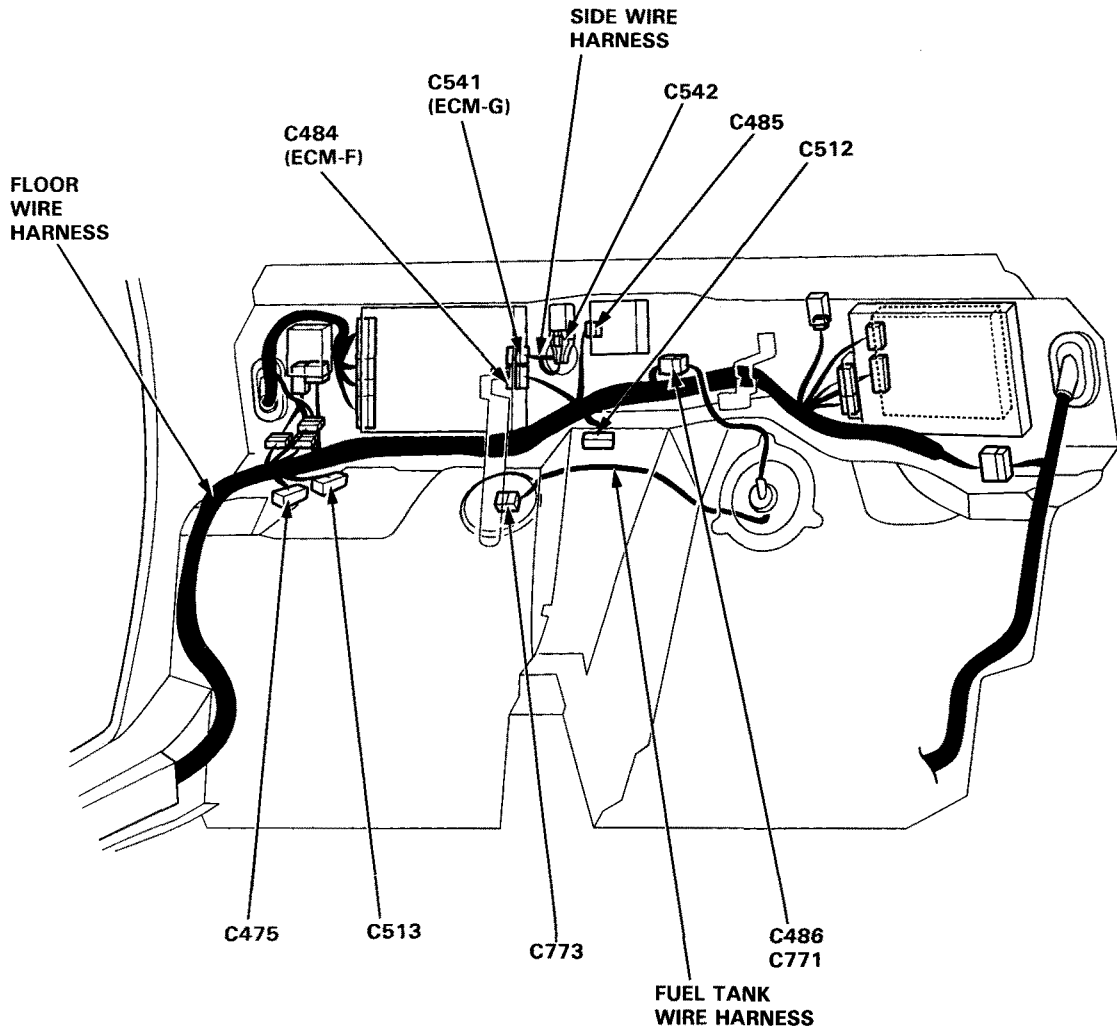



**C475**



1	WHT/YEL	11	BLK
2	WHT/YEL	12	BLK
③	WHT/YEL <sub>1</sub>	13	BLK
4	WHT/YEL	14	---
5	WHT/YEL	15	---
⑥	WHT/YEL <sub>1</sub>	⑮	YEL/GRN
⑦	WHT/YEL <sub>1</sub>	⑰	YEL/GRN
8	WHT/YEL	18	---
⑨	RED/BLU	19	---
10	RED/BLU	⑳	RED/BLU

**C484 (ECM-F)**



①	YEL/WHT <sub>1</sub>	⑭	YEL/WHT <sub>2</sub>
②	GRN/WHT <sub>1</sub>	⑮	GRN/WHT <sub>2</sub>
3	---	⑯	GRN/WHT <sub>3</sub>
④	RED	17	---
5	---	⑰	BLU
⑥	GRY	19	---
⑦	LT GRN/BLK	20	---
⑧	LT GRN/RED	⑳	LT GRN/YEL
⑨	LT GRN	㉑	WHT/YEL
⑩	BLU/ORN	23	---
⑪	BLU/BLK	㉒	RED/BLU
⑫	YEL/RED	25	---
⑬	BLU/RED	26	---

**C485**



1	BRN/BLK	7	GRN/BLK
2	BLK	8	YEL/BLK
3	BLU/RED	⑨	BLU/BLK
4	GRY/BLK	10	ORN/BLU
5	LT GRN	11	---
6	---	12	GRN

**C486**

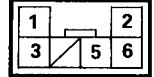

①	BLK
2	YEL/BLU
③	BLK/RED
4	---
5	YEL/WHT
6	BLK

**C512**



1	BRN/BLK	11	---
2	BRN/BLK	12	---
3	BRN/BLK	13	---
4	---	14	---
5	LT GRN/WHT	15	GRN/YEL
6	LT GRN/WHT	16	GRN/YEL
7	LT GRN/WHT	17	GRN/YEL
8	LT BLU	⑮	GRY/WHT
9	LT BLU	19	GRY/WHT
10	LT BLU	⑳	GRY/WHT

**C513**



1	BLK	⑪	BLK
2	BLK	⑫	BLK
3	BLK	13	BLK
4	BLK	14	BLK
5	WHT/YEL	15	WHT/BLU
6	WHT/YEL	16	WHT/BLU
7	WHT/YEL	17	WHT/BLU
8	GRN/RED	18	LT GRN/RED
9	GRN/RED	19	LT GRN/RED
10	GRN/RED	20	LT GRN/RED

**C541 (ECM-G)**

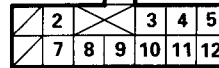

1	---	⑦	BLK <sub>1</sub>
②	GRN/RED <sub>1</sub>	⑧	BLK <sub>2</sub>
③	GRN/RED <sub>2</sub>	⑨	ORN
④	BRN	⑩	GRN
⑤	WHT/GRN	⑪	YEL
6	---	⑫	RED

**C542**



①	GRN/RED <sub>1</sub>
②	BLK <sub>2</sub>
③	WHT/BLU
④	YEL/BLK

**C773**



①	BLK
②	BLK/RED

- NOTE:
- Different wires with the same color have been given a number suffix to distinguish them (for example, YEL/BLK<sub>1</sub> and YEL/BLK<sub>2</sub> are not the same).
  - : Related to Fuel and Emissions System.
  - — Connector with male terminals (double outline): View from terminal side
  - Connector with female terminals (single outline): View from wire side

(cont'd)

# System Description

## System Connectors [Behind the bulkhead panels] (cont'd)

---

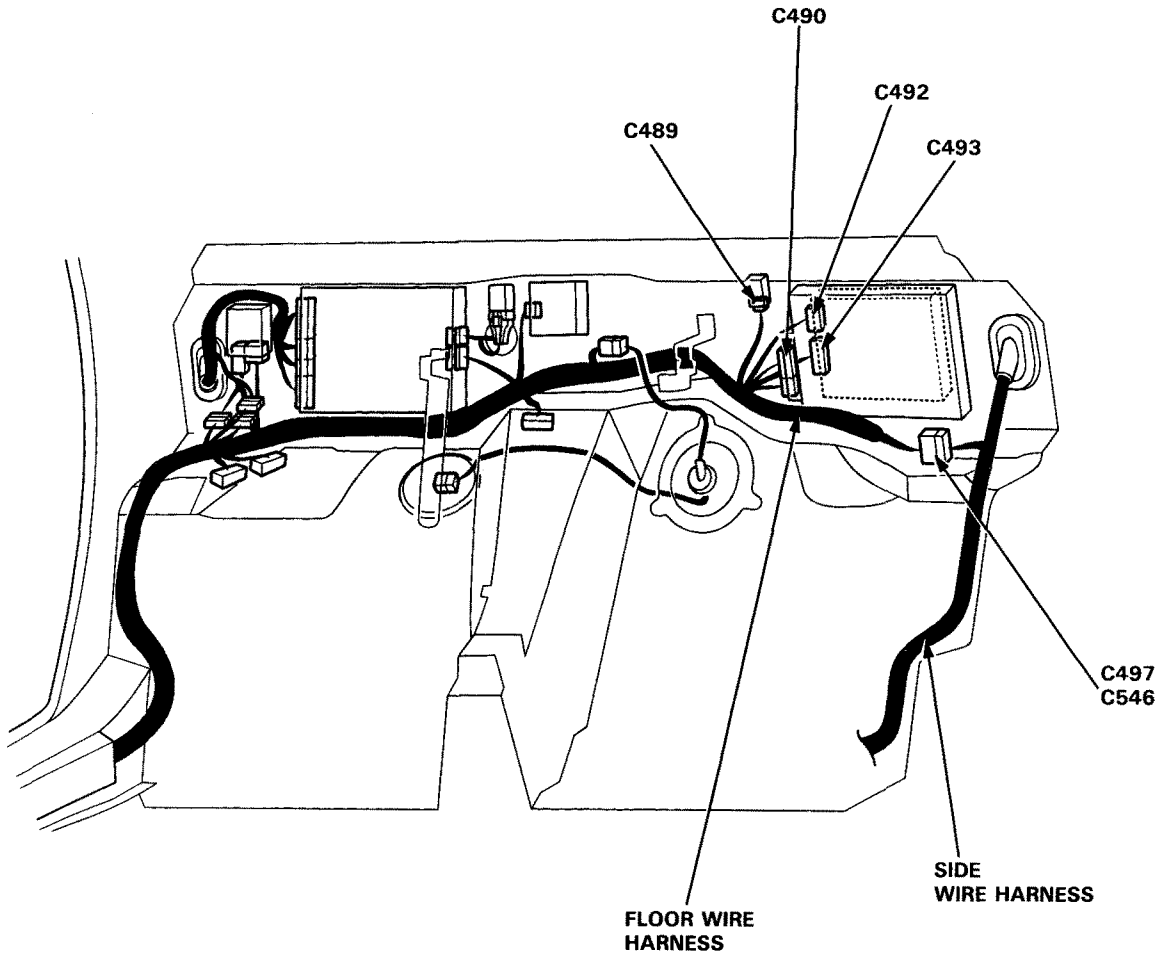



**C489**



①	BLK/YEL
②	YEL
③	BLK/RED
④	RED

**C490**



1	---	11	YEL/BLK
2	GRN/RED	12	BRN/BLK
3	---	13	---
4	---	⑬	RED/BLU
⑤	BLK	15	---
6	ORN/BLU	16	---
7	BLU	⑰	GRN
8	BLK	18	BRN/WHT
9	RED	19	BLK
10	WHT/YEL	20	---

**C492**

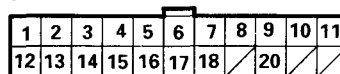

1	GRY	12	GRN/WHT
②	YEL/RED	13	ORN/BLK
③	RED/WHT	14	BLU
④	RED/BLK	15	ORN/WHT
5	ORN	16	PNK/BLK
6	BRN/YEL	17	WHT/BLU
7	BLU/ORN	18	ORN/BLU
8	BLU/YEL	19	---
9	BLU/GRN	⑳	BLU
10	ORN/BLU	21	---
⑪	WHT/YEL <sub>2</sub>	22	---

**C493**

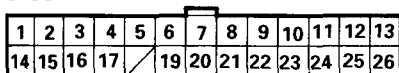

1	BLK/WHT	14	BLK
2	GRN/WHT	15	WHT/BLK
3	BLU/YEL	16	RED/WHT
4	GRY/WHT	17	YEL/BLK
⑤	GRN	18	---
6	LT GRN/WHT	⑱	LT GRN/YEL
7	GRN/YEL	⑳	WHT/YEL
8	BRN/BLK	21	LT GRN/RED
9	GRN/BLU	22	ORN/BLK
10	RED <sub>2</sub>	23	WHT/YEL
11	LT BLU	㉑	RED/BLU
12	YEL	25	YEL
13	BRN/BLK	26	BRN/BLK

**C497**

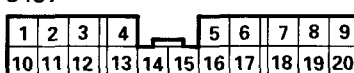

1	GRN/YEL	11	LT GRN
②	GRN	12	WHT/GRN
3	RED/YEL	13	RED/GRN
4	BLU/GRN	⑬	YEL/WHT <sub>1</sub>
⑤	YEL/BLK	⑮	WHT/YEL <sub>2</sub>
⑥	RED	⑰	GRN/WHT <sub>1</sub>
7	WHT/BLU	⑱	PNK/BLU
8	ORN	18	WHT/GRN
9	LT BLU	19	BLU/GRN
10	BLU/YEL	20	GRY

NOTE: • Different wires with the same color have been given a number suffix to distinguish them (for example, YEL/BLK<sub>1</sub> and YEL/BLK<sub>2</sub> are not the same).  
 ○: Related to Fuel and Emissions System.  
 — Connector with male terminals (double outline): View from terminal side  
 — Connector with female terminals (single outline): View from wire side

(cont'd)