

Dashboard

Component Removal/Installation

Clock and center air vent removal:

NOTE: Take care not to scratch the dashboard and related parts.

1. Remove the clock by pulling it backward from the center air vent, then disconnect the connector.
2. Remove the center air vent mounting screws.

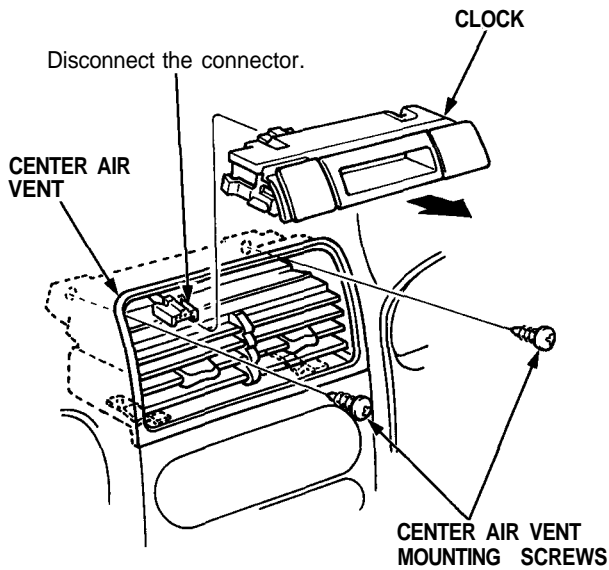

3. Insert a plastic between the center air vent and center console panel to prevent damaging them.

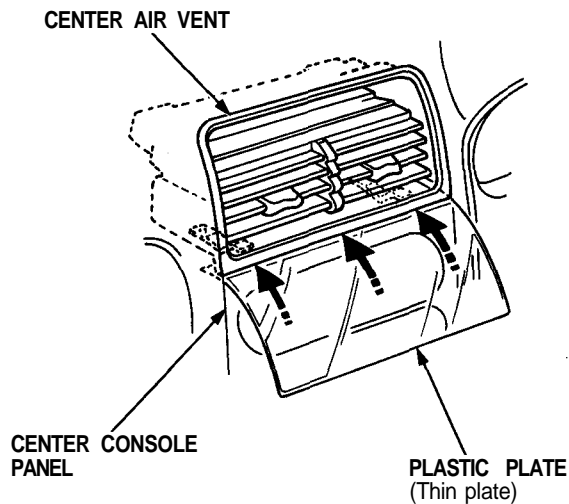

4. To make a gap between the center air vent and dashboard, pull the top of the center air vent while lowering it as shown.

NOTE: Make as large a gap as possible.

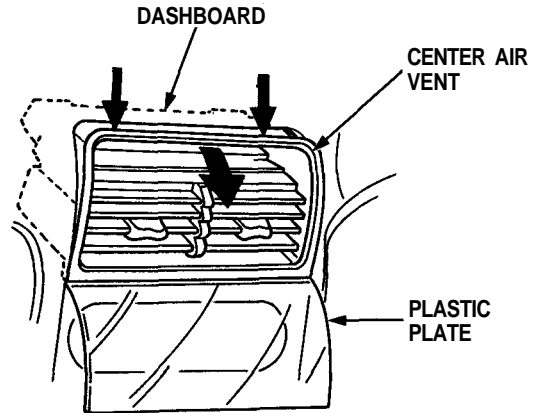

5. Insert a flat tip screwdriver between the center air vent and dashboard as shown.

NOTE: Use the correct size flat tip screwdriver as shown.

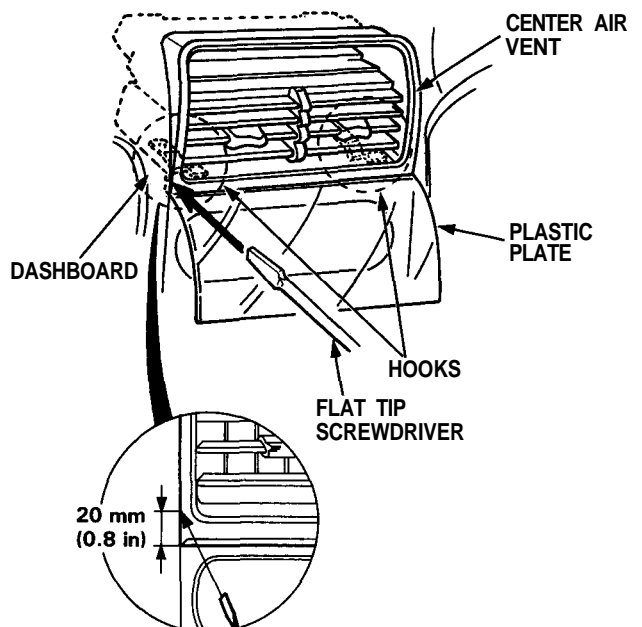
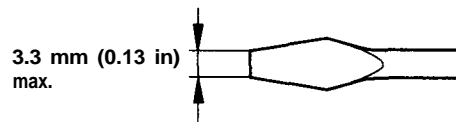



6. After inserting the screwdriver, turn it 90°.

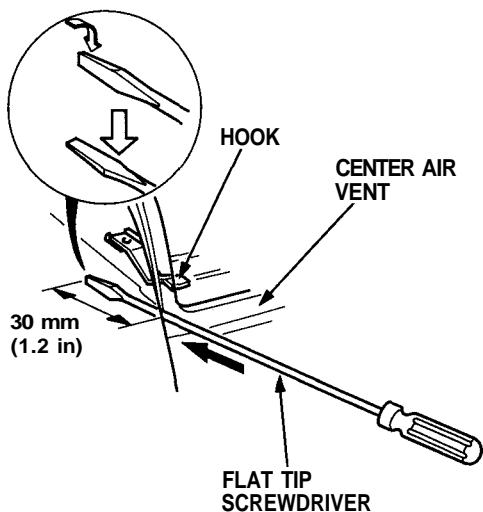

7. Insert the tip the screwdriver in under the hook by pivoting it. Detach the hook by prying it.

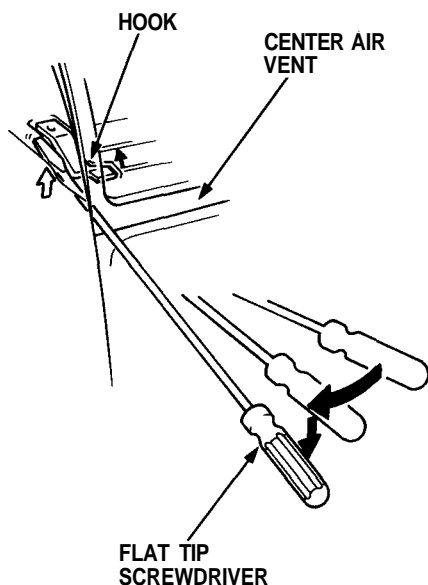

8. Pull the center air vent backward while prying the hook.

CAUTION: Use a shop towel on the dashboard to prevent damage.

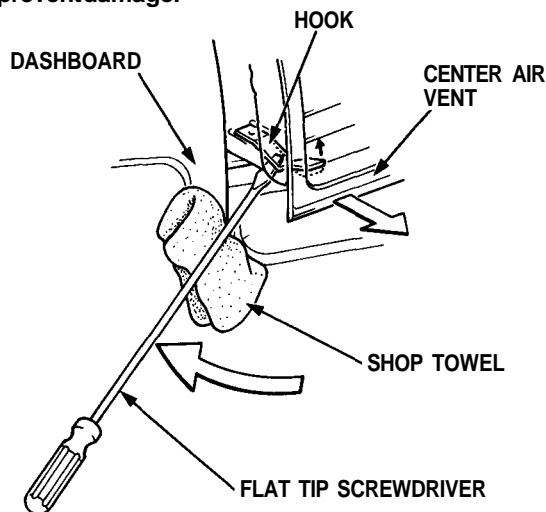

9. Detach the other hook in the same manner, then remove the center air vent.

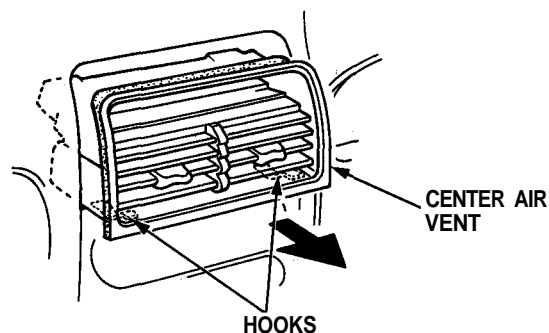

10. Install the center air vent and clock.

NOTE:

- If there is a minor dent on the dashboard, repair it by hand as shown.

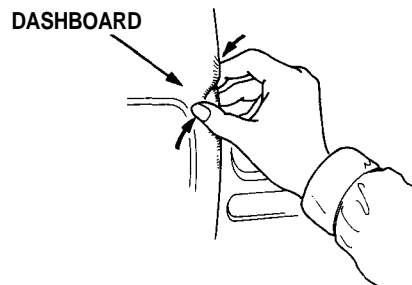

- Make sure the connector of the clock is connected properly.

(cont'd)

Dashboard

Component Removal/Installation (cont'd)

SRS components are located in this area. Review the SRS component locations, precautions, and procedures in the SRS section (24) before performing repairs or service.

Center console panel removal:

NOTE:

- Take care not to scratch the dashboard, center console panel and related parts.
- Do not drop the screws inside the dashboard.
- Remove the center armrest (see page 20-49('94-'96) ('91-'93)), clock and center air vent (see page 20-50 ('94-'96) ('91-'93)).

Disassemble in numbered sequence.

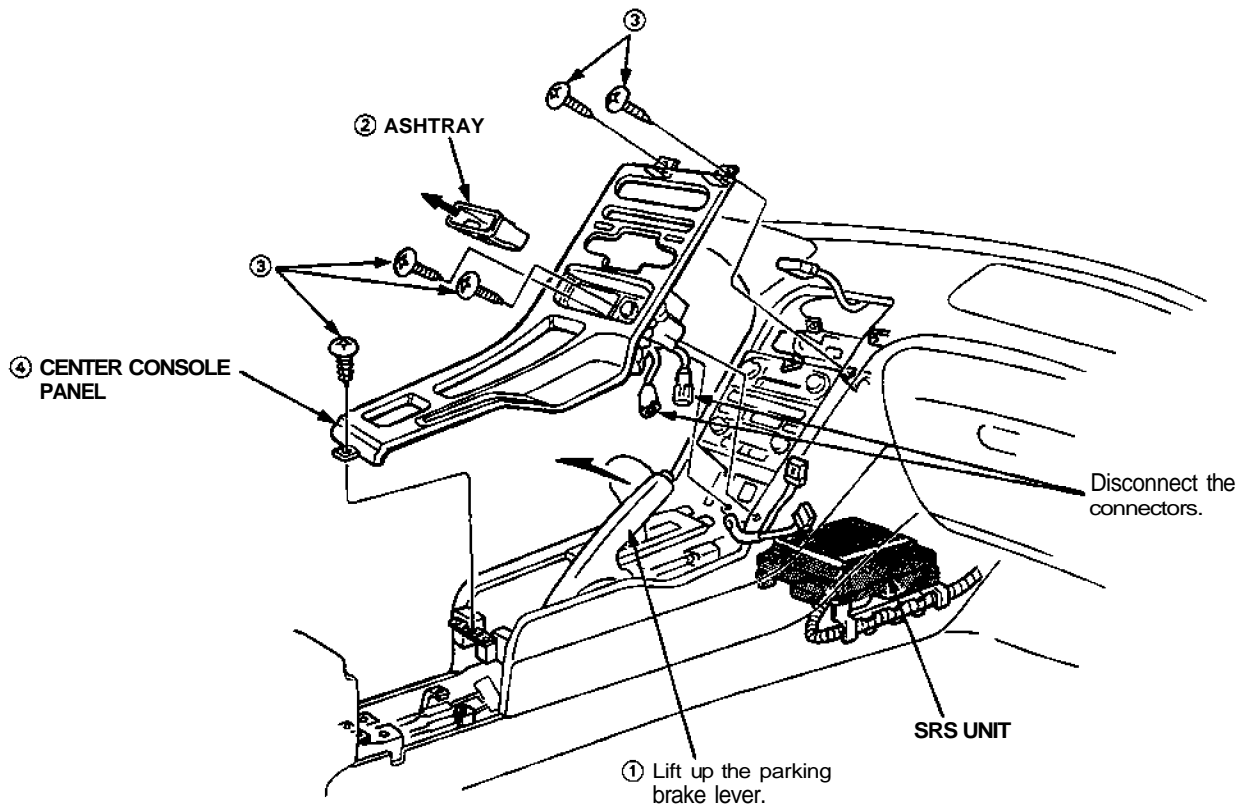

Installation is the reverse of the removal procedure.

NOTE: Make sure the connectors are connected properly.



Climate control unit, stereo cassette/radio and glove box removal:

Disassemble in numbered sequence.

NOTE: Remove the center console panel.

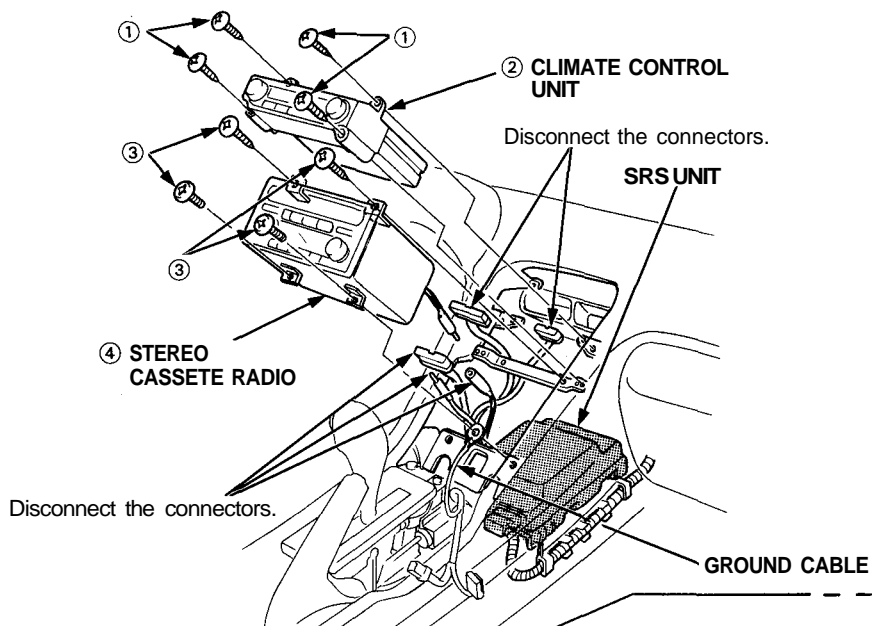

Passenger's:

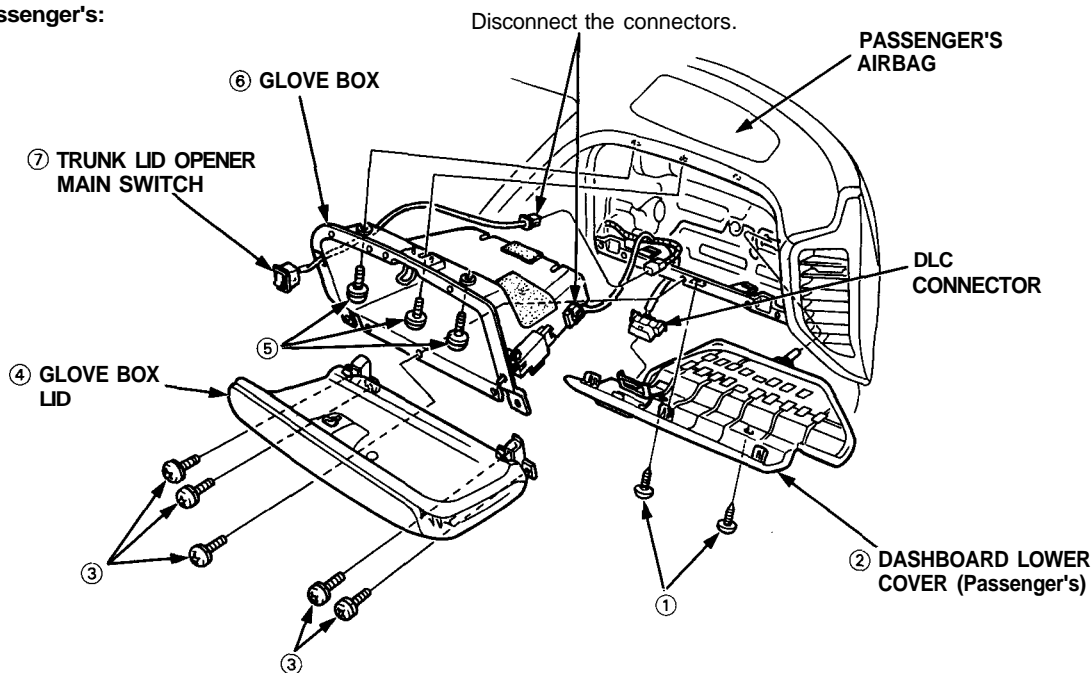

Installation is the reverse of the removal procedure.

NOTE: Make sure the connectors are connected properly.

(cont'd)

Dashboard

Component Removal/Installation (cont'd)

SRS components are located in this area. Review the SRS component locations, precautions, and procedures in the SRS [section 24](#) before performing repairs or service.

NOTE: Take care not to scratch the dashboard, steering column and related parts.

CAUTION: When prying with a flat tip screwdriver, wrap it with protective tape or a shop towel to prevent damage.

Drivers:

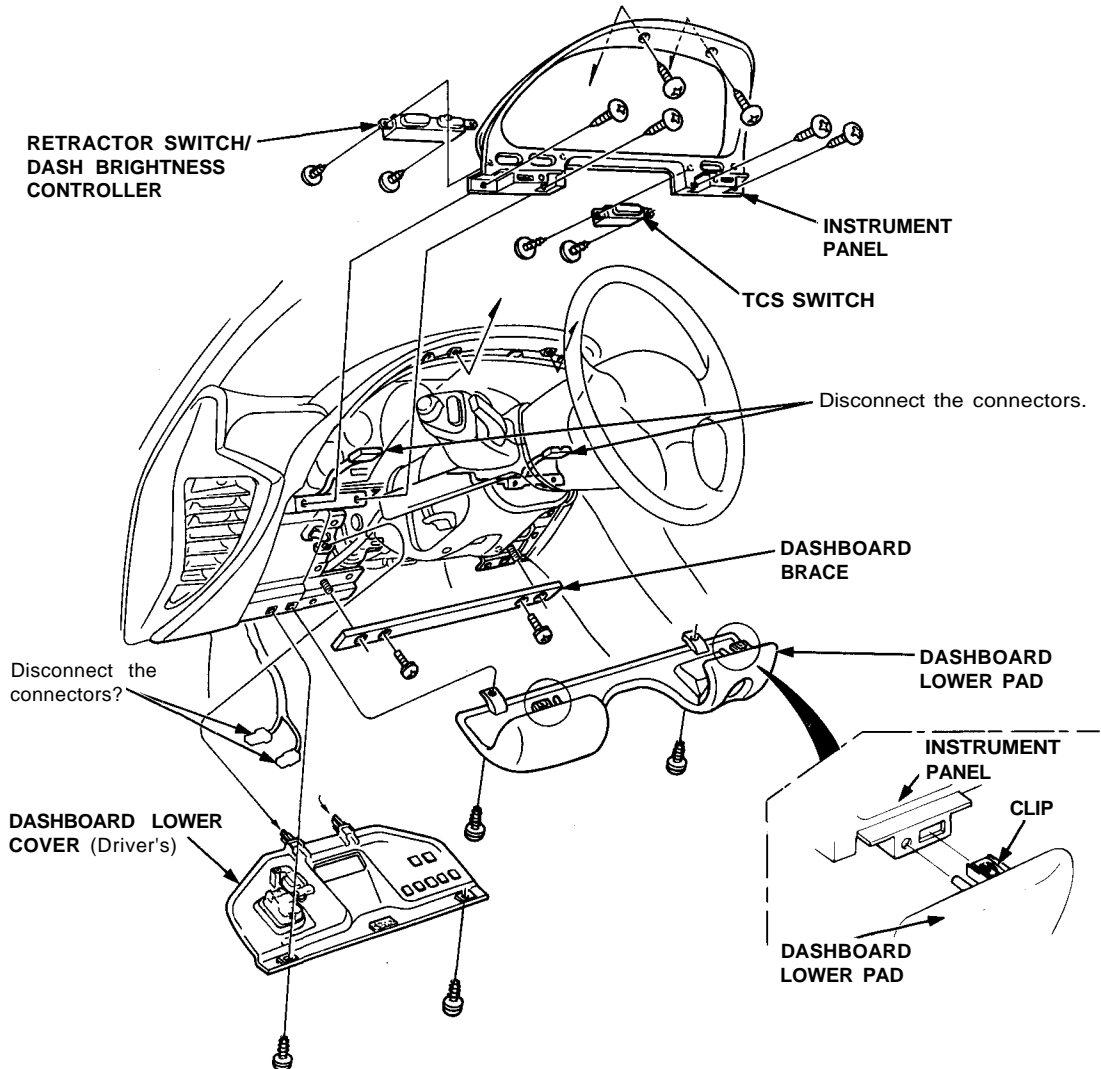

Installation is the reverse of the removal procedure.

NOTE: Make sure the connectors are connected properly.